



Events

at EAA



Welcome to EAA!

On behalf of our events team, thank you for considering EAA® as your event venue! We are excited at the possibility of working with you to create your event. With more than 1,600 acres and 26 venues to choose from, we are sure to show you a space that will make your vision come to life. From intimate wedding ceremonies and formal corporate meetings to outdoor runs and exhibitions, EAA can cater to any type of event. Our unique atmosphere is sure to offer a one-of-a-kind experience for your guests.

Starting with initial conversations regarding your specific event needs, EAA is dedicated to providing you with a premium experience while providing hands-on attention throughout the process. We take pride in making each event stand out and work with our clients to ensure every detail is fulfilled. Our turnkey approach allows us to create centerpieces, coordinate your audiovisual needs, and work with vendors ranging from musicians and production companies to florists and photographers. Plus, with a list of roughly 12 preferred caterers, you will be sure to find delicious cuisine tailored to meet your event needs.

Please contact our dedicated events team for pricing and with any questions you may have, or to move forward with the contract and planning process. Our goal is to ease your workload so, come event day, you can enjoy the time with your guests. We look forward to helping you create an event beyond your expectations!

Sincerely,
EAA Events Team



EAA® Air Academy Lodge

Make this venue your home away from home! The Air Academy Lodge is a great place for corporate retreats, family reunions, weddings, baby showers, or any type of party that requires a relaxed, homey feeling. Complete with 16 guest rooms (12 bunkrooms and 4 suites), a great room, kitchen (for caterer use only), dining room, classrooms, conference rooms, library, fireplace, pool, foosball and pingpong tables, and outdoor facilities, including an outdoor gazebo with fire pit. The rooms noted below make for great meeting and activity areas within the Air Academy Lodge.

Please inquire about overnight accommodations and pricing



Room	Seating Capacity
Great/Dining Room	54
Conference/Board Room	8

Dimensions
50,000 sq. ft.

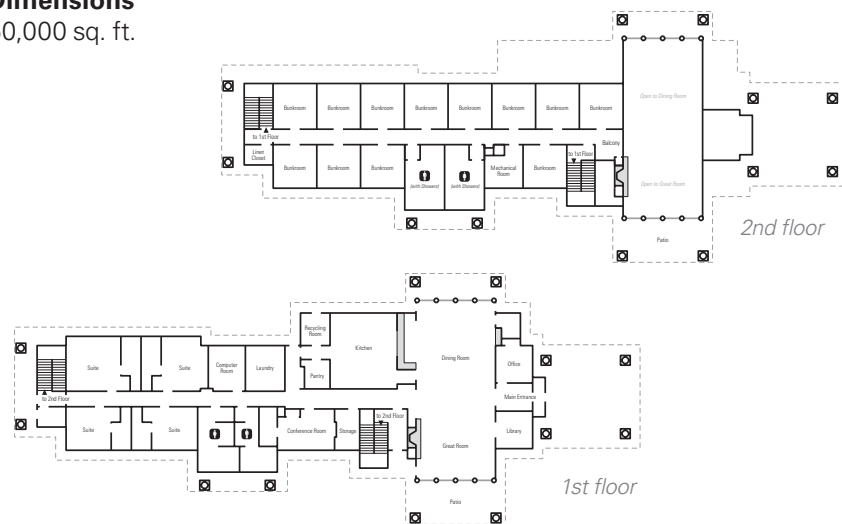

EAA® Corporate Retreat Package

Make the Air Academy Lodge your home away from home for your corporate retreat! Complete with 16 guest rooms (12 bunkrooms and 4 suites), a great room, dining room, conference room, library, fireplace, pool, foosball and ping-pong tables, and outdoor facilities, including an outdoor gazebo with firepit. Use of the Conference Center, located on the lower level of the EAA Education Center, for meetings is also included. The Conference Center has full technology capabilities to accommodate your needs.

Included With Retreat Package

- Two-day, one-night stay in the EAA Air Academy Lodge.
- Breakfast, dinner, and lunch.
- Nonalcoholic beverages.
- Access to Conference Center for meetings and lunch.
- Dinner in an exhibit space at the EAA Aviation Museum.
- Linens and centerpieces.
- Museum admission for attendees and guided tour upon request.
- Available for booking January through May, and September through November, each year

Available Premium Upgrades:

- Team building activities.
- Gourmet hors d'oeuvres (market rate).
- Premium alcohol package and bar service (market rate).
- Additional guest spaces (offered at a reduced rate).



EV_FSS24P_CR-SS_V011325

EAA Aviation Museum™

This space is one of the most remarkable venues available anywhere for meetings, receptions, or gatherings. Nearly 100 aircraft are displayed throughout the museum, offering much more than the standard event atmosphere for your group. There are numerous galleries within the EAA Aviation Museum that provide outstanding backdrops for your event.

Museum Exhibit Areas

Pioneer Airport Exhibit Area
Spirit of St. Louis Exhibit Area
Air Race Gallery Exhibit Area
SpaceShipOne Exhibit Area

See your event coordinator to discuss capacity quantities for your event.

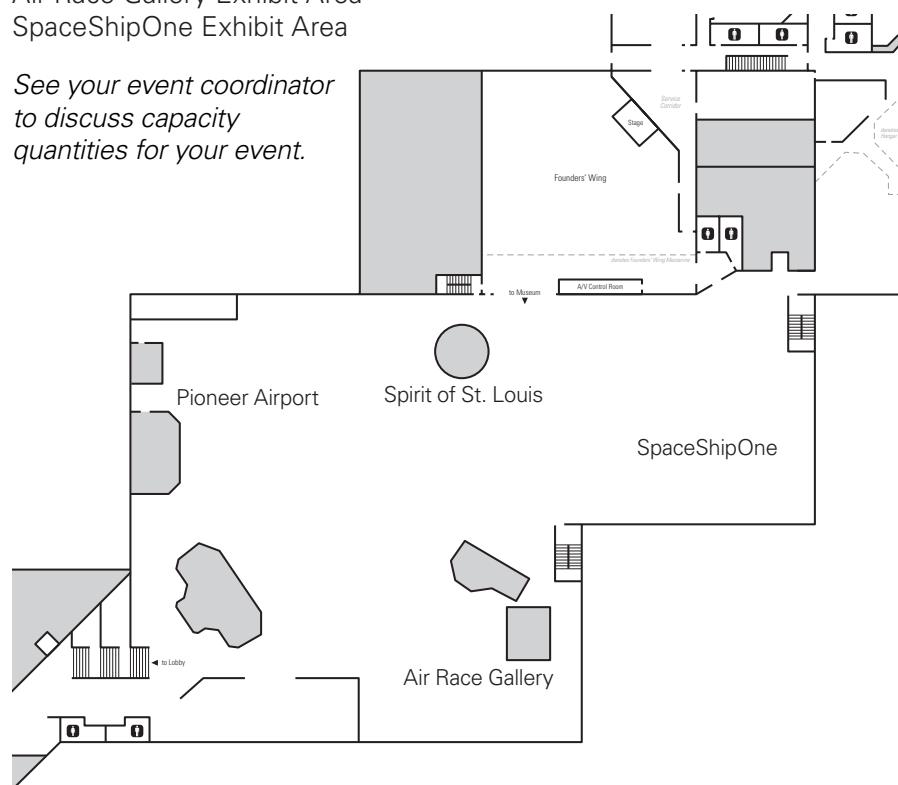

EAA Aviation Museum™ Lobby

The magnificent “Tower of Aviation” welcomes your guests to the EAA® Aviation Center, creating a striking setting for any gathering. The lobby is the perfect place for meeting registration and greeting or for hors d’oeuvres and cocktail receptions.

Dimensions

55' 2" W x 124' 4" L (1,500 sq. ft.)

Seating Capacity

Rounds: 50 Theater: 100

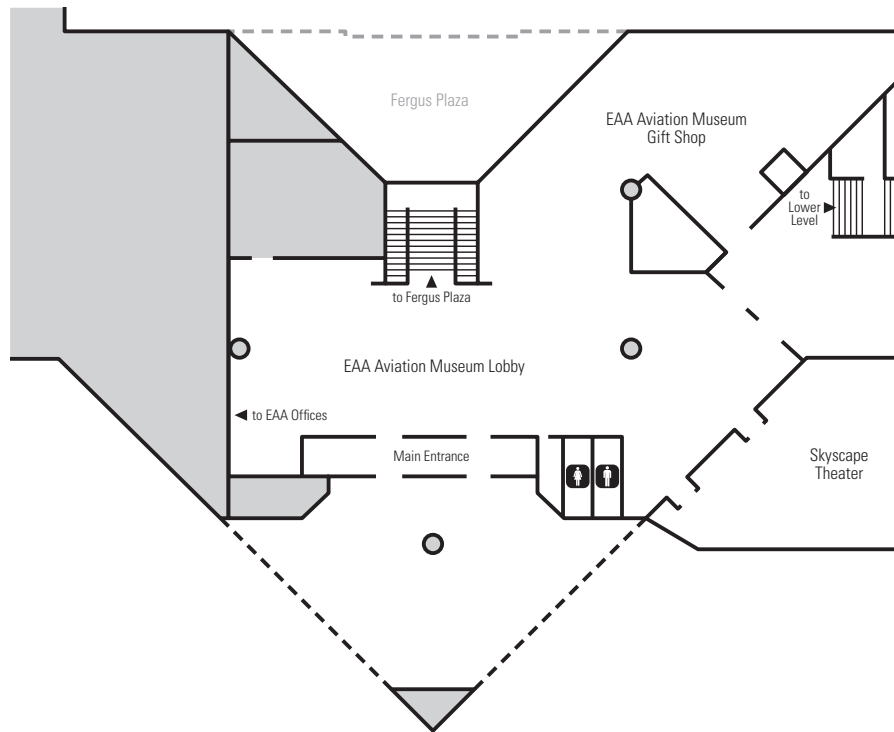

Batten Boardroom

Located on the lower level of the EAA Aviation Center, the Batten Boardroom offers privacy and comfort in an exceptional meeting facility. It also has full technology capability to accommodate your needs. If desired, you can take the edge off a winter chill or add the right casual touch with the in-room fieldstone fireplace. The Batten Boardroom overlooks the Leeward Plaza and Pioneer Airport and is adjacent to the Fergus Plaza.

Dimensions

26' W x 40' 5" L (873 sq. ft.)

Seating Capacity

Conference: 26

AV Equipment Included*

WUXGA ceiling-mounted projector (1)

4.25' H x 7.5' W roll-down screen (1)

55" mounted HDTV (1)

PC laptop (1)

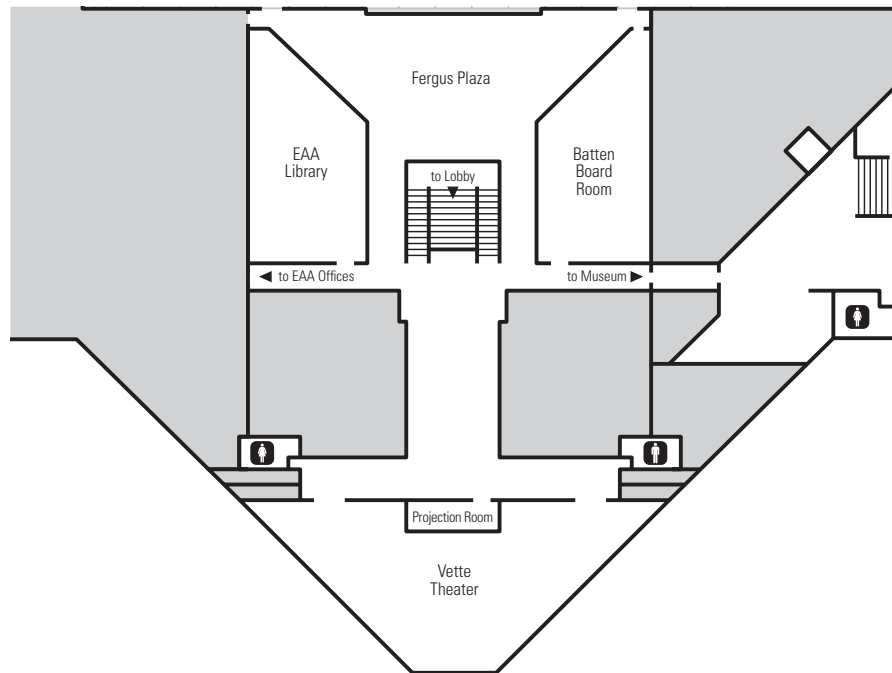

**Please see your event coordinator for additional audiovisual details.*

Conference Center Boardroom

Located on the lower level of the brand-new EAA® Education Center, the Conference Center Boardroom is an ideal space for small business meetings. It is equipped with state-of-the-art videoconferencing equipment, perfect for utilizing Web-based programs such as Zoom or Microsoft Teams.

AV Equipment Included*

85" wall-mounted TV
Camera/microphone array system
Wireless keyboard & mouse
PC laptop (1)

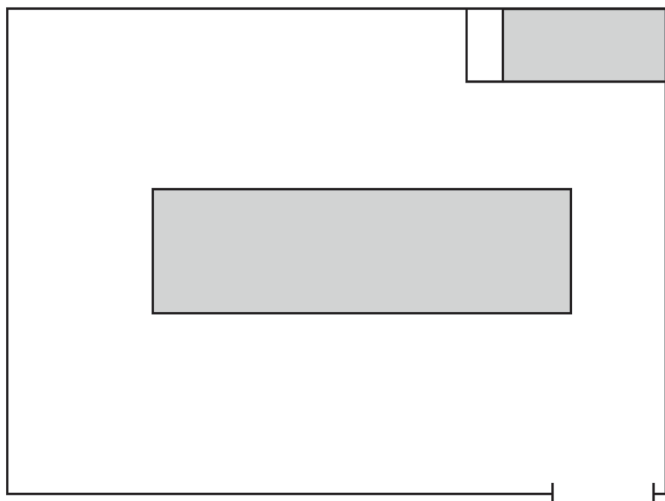

Dimensions

Width: 20' 7"
Length: 14' 6"
Sq. Ft.: 298' 6"

Seating Capacity

Conference: 12



**Please see your event coordinator for additional audiovisual details.*

Eagle Hangar

Our largest, and perhaps the most visually impressive space within the EAA Aviation Museum™, the Eagle Hangar houses restored military aircraft to create an unmatched backdrop of nostalgia. With history, class, and space for any aspect you need at your event, from place cards and gift tables to bars to a photo booth, this is the perfect venue for all types of events ranging from weddings to corporate meetings.

Dimensions

186' W x 186' 10" L (34,596 sq. ft.)

Seating Capacity*

Theater: 600 Banquet: 300

Classroom: 300

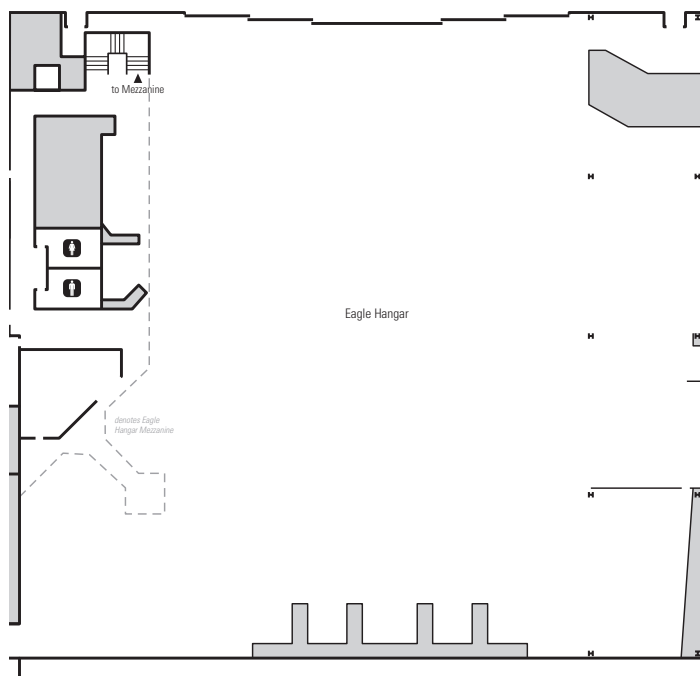

**Capacity based on set-up of area. Please contact your event coordinator to discuss floor plan options.*

Education Center Conference Rooms

Located on the lower level of the brand new EAA® Education Center, the Conference Center offers privacy and comfort in an exceptional meeting facility. It also has full technology capability to accommodate your needs. The Conference Center can be booked in its entirety as one space or can be divided into smaller rooms, depending on your group's size and needs.

AV Equipment Included*

- Wireless handheld mic
- Wireless lavalier (lapel) mic
- 2 10' x 6' screens and 2 projectors at front of room
- 4 75" TV monitors hung from ceiling - 2 on each side of room

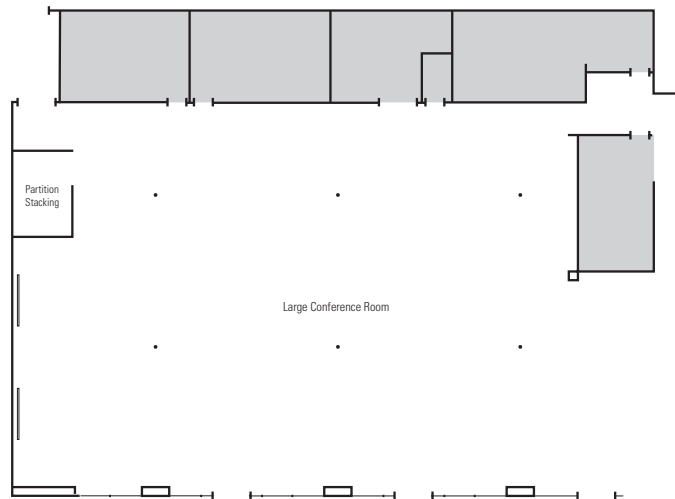

Dimensions:
82' 7" x 53' 8.5"

Seating Capacity:
Theater: 300
Rounds: 200
Classroom: 100

*Please see your event coordinator for additional audiovisual needs

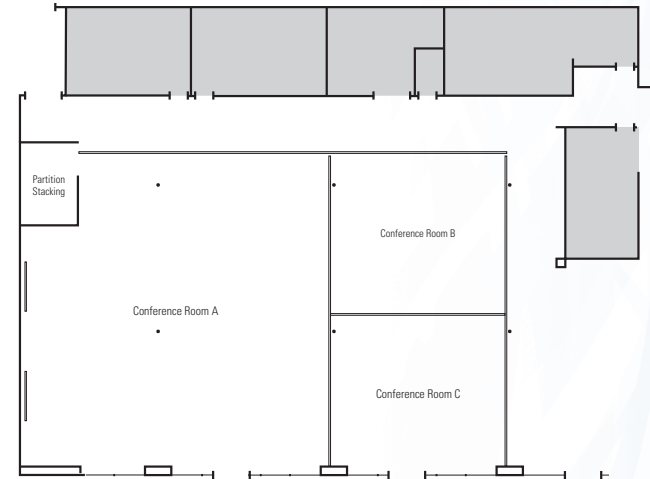

Conference Room A: AV Equipment*

- PA system
- Wireless handheld mic
- Wireless lavalier (lapel) mic
- 2 10'x6' screens and 2 projectors at front of room
- 2 75" TV monitors hung from ceiling – 1 on each side of room

Dimensions: 52' 2" x 53' 8.5"

Seating Capacity:
Theater: 125
Rounds: 72
Classroom: 48

Conference Rooms B & C: AV Equipment*

- PA system
- Wireless mic if needed
- 1 75" TV monitor for presentations

Dimensions:
Room B: 30' 5" x 27' 7"
Room C: 30' 5" x 26'

Seating Capacity:
Theater: 40
Rounds: 32
Classroom: 24

Exhibit Hangars

There are no better convention/exhibit facilities in the area than these four hangars located on the EAA AirVenture grounds. Each summer, the buildings welcome hundreds of aviation exhibitors from around the world and supply their logistical needs. Located close enough together to allow for an easy walk to any of them if space in multiple hangars is needed, the layout is perfect for organizing your event, convention, festival, or exposition show needs, with plenty of adjacent parking room and even an aircraft taxiway if needed. Outdoor exhibit space and camping facilities are available upon request.

Dimensions

Hangar A (heat & electricity):	200' W x 200' L (40,000 sq. ft.)
Hangar B (restrooms, heat, & electricity):	200' W x 200' L (40,000 sq. ft.)
Hangar C (restrooms, heat, & electricity):	200' W x 290' L (58,000 sq. ft.)
Hangar D (heat & electricity):	200' W x 200' L (40,000 sq. ft.)

Seating Capacity	Banquet	Rounds	Theater	Classroom
Hangar A:	2,500	2,500	4,000	500
Hangar B:	2,500	2,500	4,000	500
Hangar C:	4,000	3,500	6,450	500
Hangar D:	2,500	2,500	4,000	500

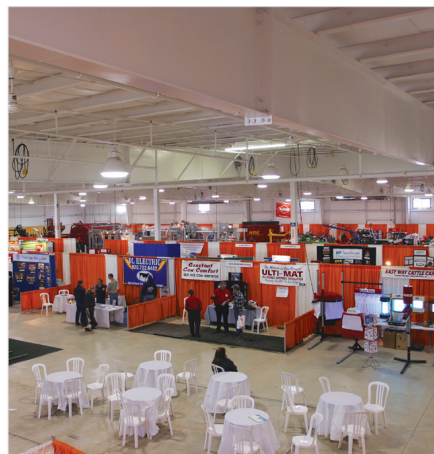
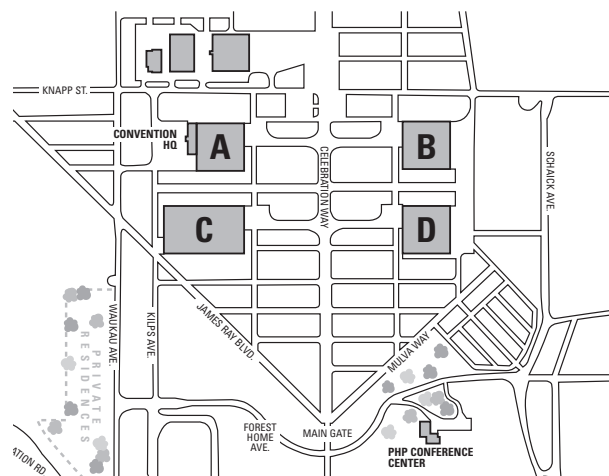

Fergus Chapel

A quaint, old-time chapel located next to a quiet pond – the perfect backdrop for beautiful pictures – the Fergus Chapel provides an intimate setting for weddings, baptisms, or memorial services. The chapel is located between the EAA® Nature Center and Pioneer Airport and includes easy, separate access off Waukau Avenue.

Dimensions

27' W x 39' L (1,026 sq. ft.)

Seating Capacity

Theater: 80

AV Equipment Included*

Podium with wired microphone (1)



**Please see your event coordinator for additional audiovisual details.*

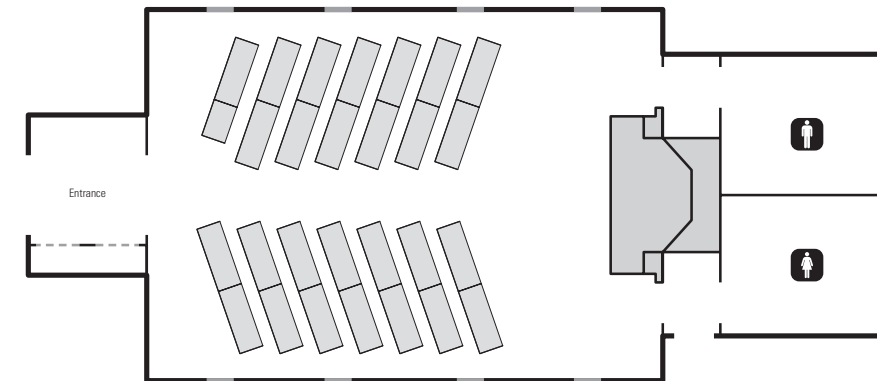

Fergus Plaza

A two-story panoramic view greets guests to the Fergus Plaza, conveniently located on the lower level of the EAA Aviation Museum™, and just inside the main entrance. The view looks out on Leeward Plaza and EAA's picturesque Pioneer Airport, a remarkable re-creation of a 1930s aerodrome. Ideal for receptions, private luncheons, and after-hours events, the Fergus Plaza is also conveniently located adjacent to a small catering kitchen.

Dimensions

74' W x 32' L (1,796 sq. ft.)

Seating Capacity

Theater: 100

Rounds: 70

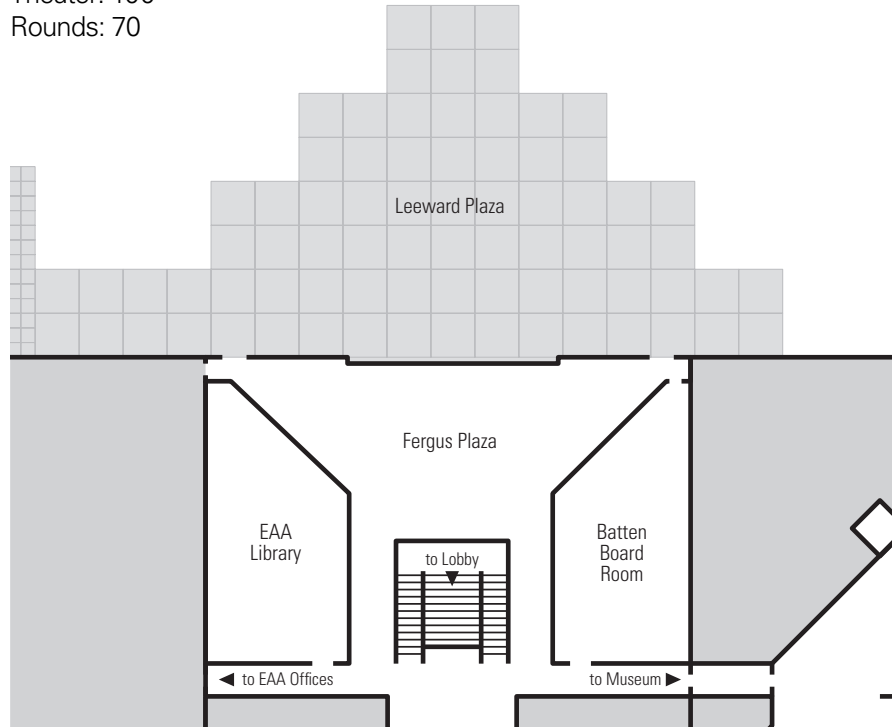

Founders' Wing

Dedicated to preserving EAA®'s heritage and culture for future generations, the Founders' Wing highlights EAA's significant accomplishments throughout its history. The main floor can accommodate up to 400, surrounding your guests with the history of EAA's annual convention, AirVenture, since 1953. An intimate atmosphere awaits on the mezzanine level, where your guests can enjoy viewing the Founders' Library and the EAA Legacy Wall while overlooking suspended aircraft and aviation artwork.

Dimensions

77' 10" W x 95' L (7,400 sq. ft.)

AV Equipment Included*

HD ceiling-mounted projector (1)
11.25' H x 20' W roll-down screen (1)
In-house PA system
Wireless microphones (2)
Lavalier microphones (2)
PC laptop (1)

Seating Capacity

Theater: 400
Rounds: 240
Classroom: 100

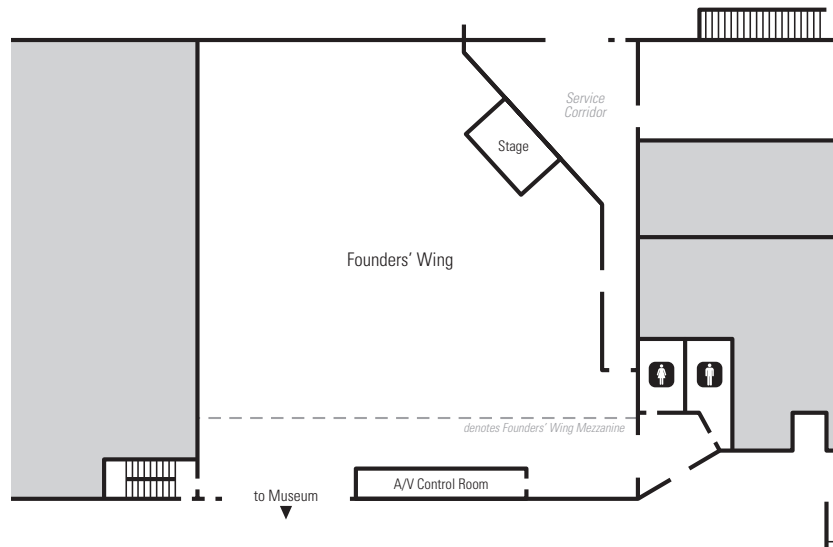

**Please see your event coordinator for additional audiovisual details.*

Leadership Classroom

This educational space for classroom presentations, meetings, or information sessions includes internet connections and updated technology. The classroom is also an outstanding staging area or greenroom for larger events that take place in the Eagle Hangar or other EAA Aviation Museum™ areas.

Dimensions

35' 9" W x 36' 2" L (1,326 sq. ft.)

Seating Capacity

Hollow Square: 40

Classroom: 34

AV Equipment Included*

XGA ceiling-mounted projector (1)

4.75' H x 6.5' W roll-down screen (1)

In-house PA system

PC laptop (1)

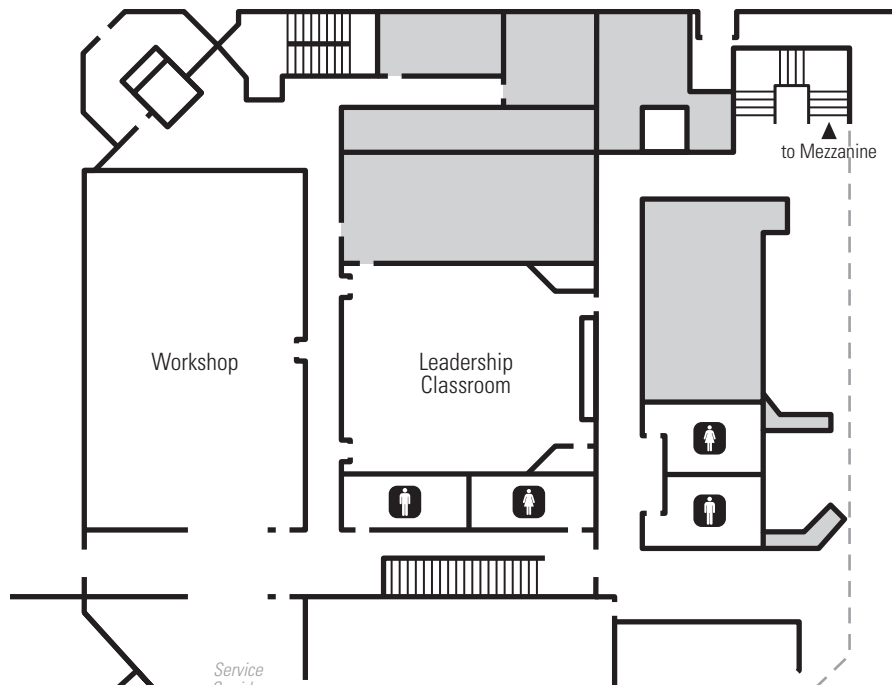

**Please see your event coordinator for additional audiovisual details.*

Leeward Plaza

Located just outside the doors of the Fergus Plaza, the Leeward Plaza is the perfect choice for an outdoor wedding ceremony or casual reception. Not only does the location have all the amenities of the adjacent museum, it also features EAA®'s Pioneer Airport, providing a stunning aviation backdrop. Convenient drive-up facilities for caterers and other logistics make this an easy area to set up and tear down. Includes grass area.

Dimensions

104' W x 64' L (4,480 sq. ft.)

Seating Capacity*

Rounds: 160 Theater: 75

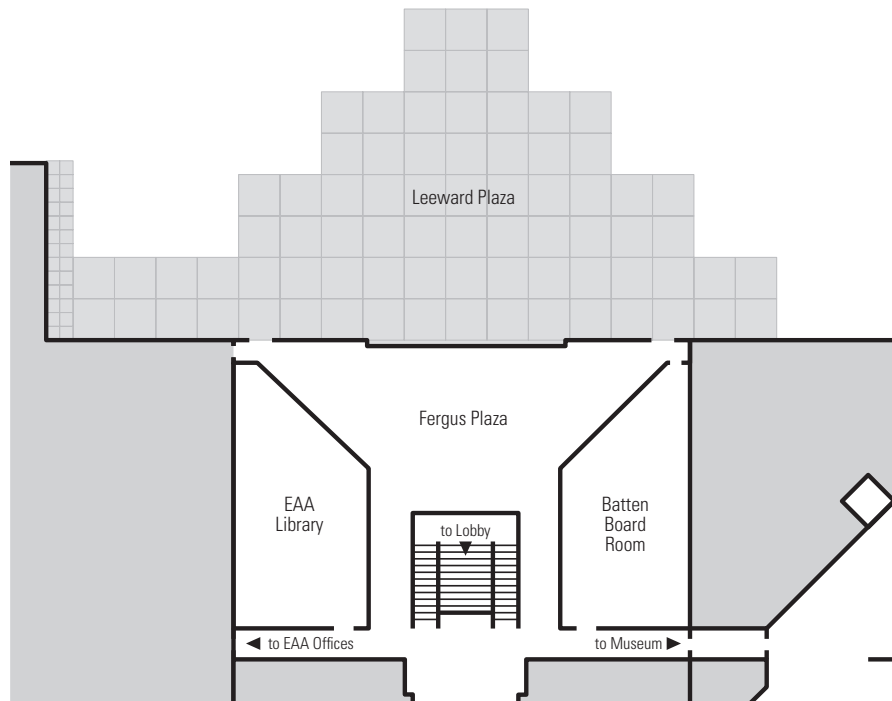

**Additional capacity on grass lawn*

Nature Center Pavilion

Located east of the EAA® Aviation Center in a wooded area, the beautiful pondside Nature Center Pavilion is the perfect setting for your wedding reception, company picnic, or outdoor event. Along with easy Waukau Avenue access, the Nature Center Pavilion features overhead doors that can bring in or keep out the weather. The pavilion is surrounded by an open area for parking or group activities.

Dimensions

60' W x 100' L (6,000 sq. ft.)

Seating Capacity

Picnic Tables: 300



Please contact your event coordinator for additional seating styles. Fees may apply.

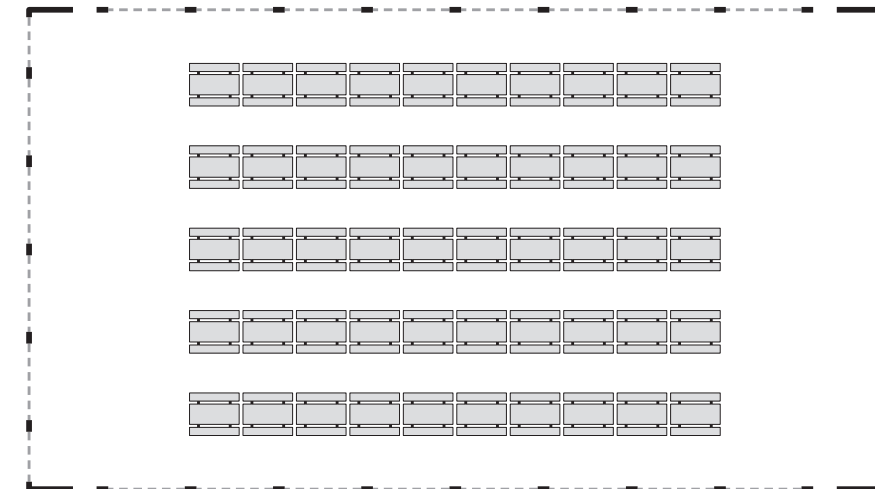

Gray dashed lines represent overhead doors.

Vette Theater

EAA's state-of-the-art amphitheater can accommodate major video presentations with comfortable theater seating for 116. Each seat also has a slide-away writing surface, making it the ideal setting for meetings that require note-taking. A private stairway entrance can be used to reach the facility.

Food and beverages are not allowed in the Vette Theater.

Dimensions

1,667 sq. ft.

Seating Capacity

Theater: 116

AV Equipment Included*

XGA ceiling-mounted projector (1)
7.5' H x 10' W screen
In-house PA system
Podium with one wired microphone (1)
Wireless microphone (1)
Lavalier microphone (1)
PC laptop (1)

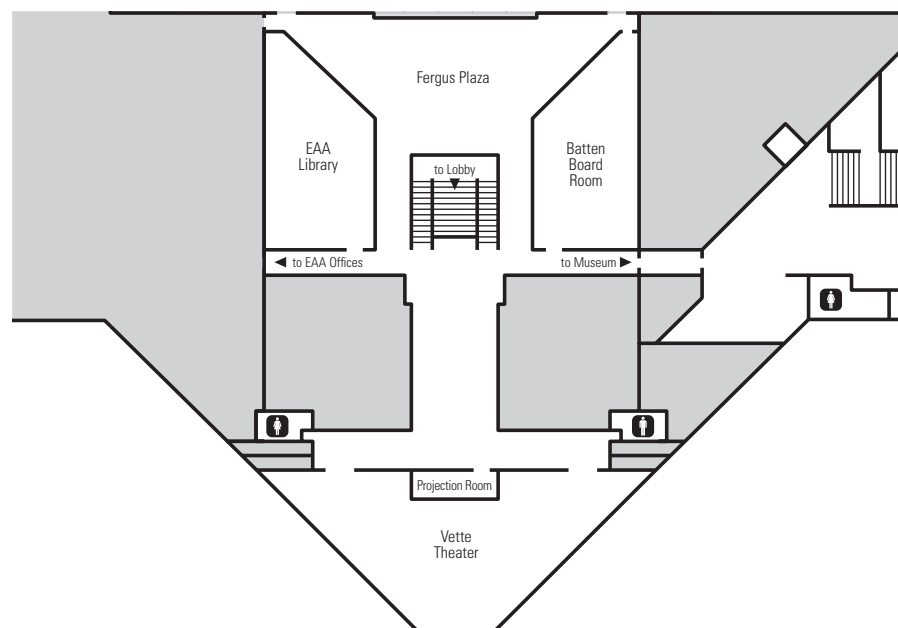

**Please see your event coordinator for additional audiovisual details.*

Approved Caterers

Annie's Fountain City Catering

51 W Division St, Fond du Lac, WI 54935

Contact: Ann Culver

(920) 948-9393 | anniescatering23@gmail.com

Becket's

1 City Center, Oshkosh, WI 54901

Contact: Kris Larson

(920) 230-3333 | kris@becketrestaurant.com

The Chalice

1741 North Main Street, Oshkosh, WI 54901

Contact: Joe Ambrose

(920) 233-4400 | ambrose92002@yahoo.com

Chick Fil A

1047 N Washburn St, Oshkosh, WI 54904

Contact: Rita Bye

(920) 232-9215 | catering@cfaoshkosh.com

El Agave Mexican Grill & Cantina

1750 N Casaloma Dr, Appleton, WI 54913

Contact: Renee Hernandez

(920) 327-3136 | el.agave2018@gmail.com

Faris Gourmet Popcorn

770 W Scott St, Fond du Lac, WI 54937

Contact: Alison Helleberg

(920) 921-1347 | sales@farispopcorn.com

The Hangar

1485 West 20th Avenue, Oshkosh, WI 54902

Contact: Lisa Marshall

(920) 233-7430 | info@thehangaroshkosh.com

Jimmy John's

412 S Koeller St, Oshkosh, WI 54901

Contact: General Manager

(608) 232-6600 | koeller@jjspm.com

LaSure's

1570 Ripon Lane, Oshkosh, WI 54901

Contact: Talia Stone

(920) 651-0796 | talias@lasures.com

Machine Shed Restaurant

220 N. Fox River Drive, Grand Chute, WI 54913

Contact: Robert Wall

(920) 830-2326 | rwall@hoari.com

Michiels Catering

1100 Appleton Road, Menasha, WI 54952

Contact: Jennifer Michiels

(920) 731-7271 | info@michielscatering.com

Oshkosh Waterfront Hotel & Convention

1 North Main Street, Oshkosh, WI 54901

Contact: Christy Marquardt

(920) 230-6289 | christine.marquardt@scarletthotelgroup.com

Osorio's Latin Fusion

1910 North Casaloma Drive, Appleton, WI 54913

Contact: Stephanie Peters

(920) 955-3766 | steph.osorios.events@gmail.com

Papa John's Pizza

150 Wisconsin Street, Oshkosh, WI 54901

Contact: Mary Ziola-Vega

(708) 289-0596 | maryzvpapajohns@gmail.com



*ALL alcoholic beverage service
must be contracted through EAA .*

Approved Caterers

Parker John's BBQ & Pizza

124 Main Street, Menasha, WI 54952

Contact: Jordan Saunders

(920) 395-1370 | jordan@viandhospitality.com

The Roxy

571 N. Main Street, Oshkosh, WI 54901

Contact: Ryan Wolf

(920) 379-5622 | theroxy@ntd.net

Stone Arch Catering

1004 South Olde Oneida Street, Appleton, WI 54915

Contact: Beki Grygny

(920) 997-3332 | catering@stonearchbrewpub.com

Subway

277 S Bluemound Drive, Appleton, WI 54914

Contact: Cara Schmick

(920) 251-5094 | homestead08@outlook.com

Thunder Bay

N14W24130 Tower Place, Waukesha, WI 53188

Contact: Laura Michel

(262) 523-4244 | lmichel@hoari.com

Tysinger Promotions (TPI)

PO Box 12588, 601 McCarthy Blvd., New Bern, NC 28561

Contact: Wendy Stallings

(252) 636-0033 | wendy@tpieventsolutions.com

Teriyaki Madness

1834 Oshkosh Ave, Oshkosh, WI 54904

Contact: Nathan Krohn

(920) 385-1592



*ALL alcoholic beverage service
must be contracted through EAA .*

Standard Beverages

Guests 21 and older with valid ID are permitted to consume alcohol.



Spirits	Single Price	Double Price
Bacardi Silver	\$6.00	\$8.00
Canadian Club	\$6.00	\$8.00
Captain Morgan	\$6.00	\$8.00
Christian Brothers	\$6.00	\$8.00
Dewar's	\$6.00	\$8.00
Jack Daniels	\$6.00	\$8.00
Jim Beam	\$6.00	\$8.00
Johnnie Walker Red	\$6.00	\$8.00
Malibu	\$6.00	\$8.00
Sauza Blue Reposado	\$6.00	\$8.00
Smirnoff	\$6.00	\$8.00
Tanqueray	\$6.00	\$8.00

RTD Cocktails	Price
Central Standard Bourbon Old Fashioned	\$9.00
Central Standard Brandy Old Fashioned	\$9.00
Central Standard Cherry Vodka Lemonade	\$9.00

Wine	By the Glass	By the Bottle
Jacob's Creek Moscato	\$6.00	\$30.00
Silver Gate Cabernet	\$6.00	\$30.00
Silver Gate Chardonnay	\$6.00	\$30.00
Silver Gate Pinot Grigio	\$6.00	\$30.00

Champagne (By Bottle Only)	Price
J. Roget	\$20.00

Soft Drinks	Price
Aquafina Water	\$2.00
Pepsi	\$2.00
Diet Pepsi	\$2.00
Mountain Dew	\$2.00
Diet Mountain Dew	\$2.00
Starry	\$2.00
Starry Zero Sugar	\$2.00

Beer	Price
Miller Lite	\$5.00
Miller High Life	\$5.00
Capital Amber	\$6.00
Third Space Happy Place	\$6.00
New Glarus Spotted Cow	\$6.00
Leinenkugel's Seasonal	\$6.00
Modelo Especial	\$6.00
Guinness Draught	\$6.00
Simply Spiked Lemonade	\$6.00
Truly Assorted Seltzers	\$6.00
Stone Arch Scottish Ale	\$6.00

Barrel Service (Half-Barrel Keg)	Price
Miller Lite	\$300.00
Miller High Life	\$300.00
Coors Light	\$300.00
Capital Amber	\$350.00
Leinenkugel's Seasonal	\$350.00
New Glarus Spotted Cow	\$350.00
Special Order*	Consult Event Coordinator

18% service charge and applicable sales tax will be added to all hosted beverage sales. There is a \$100 bartender fee for each bartender required.

**Special product available for purchase. Please contact your event coordinator for details.*

Pricing and selections are subject to change.

Alcohol service is available starting at 5:00 p.m.

EV_FSS25P-YRBP_V021725

Premium Beverages

Guests 21 and older with valid ID are permitted to consume alcohol.

Spirits

	Single Price	Double Price
Absolut	\$7.00	\$9.00
Aviation Gin	\$7.00	\$9.00
Bacardi 8	\$7.00	\$9.00
Bacardi Silver	\$7.00	\$9.00
Bombay Sapphire	\$7.00	\$9.00
Captain Morgan	\$7.00	\$9.00
Crown Royal	\$7.00	\$9.00
Jack Daniels	\$6.00	\$9.00
Johnny Walker Black	\$7.00	\$9.00
Korbel	\$7.00	\$9.00
Maker's Mark	\$7.00	\$9.00
Malibu	\$7.00	\$9.00
Sauza Blue Reposado	\$7.00	\$9.00
Southern Comfort	\$7.00	\$9.00
The Glenlivet 12	\$7.00	\$9.00
Tanqueray 10	\$7.00	\$9.00

RTD Cocktails

	Price
Central Standard Bourbon Old Fashioned	\$9.00
Central Standard Brandy Old Fashioned	\$9.00
Central Standard Cherry Vodka Lemonade	\$9.00

Wine

	By the Glass	By the Bottle
Stel + Mar Rose	\$8.00	\$40.00
Kendall Jackson Chardonnay	\$8.00	\$40.00
Louis Martini Cabernet	\$8.00	\$40.00
Stoneleigh Sauvignon Blanc	\$8.00	\$40.00

Champagne (By Bottle Only)

	Price
Chandon Brut	\$40.00

Soft Drinks

	Price
Aquafina Water	\$2.00
Pepsi	\$2.00
Diet Pepsi	\$2.00
Mountain Dew	\$2.00
Diet Mountain Dew	\$2.00
Starry	\$2.00
Starry Zero Sugar	\$2.00



Beer

	Price
Miller Lite	\$5.00
Miller High Life	\$5.00
Capital Amber	\$6.00
Third Space Happy Place	\$6.00
New Glarus Spotted Cow	\$6.00
Leinenkugel's Seasonal	\$6.00
Modelo Especial	\$6.00
Guinness Draught	\$6.00
Simply Spiked Lemonade	\$6.00
Truly Assorted Seltzers	\$6.00
Stone Arch Scottish Ale	\$6.00

Barrel Service (Half-Barrel Keg)

	Price
Miller Lite	\$300.00
Miller High Life	\$300.00
Coors Light	\$300.00
Capital Amber	\$350.00
Leinenkugel's Seasonal	\$350.00
New Glarus Spotted Cow	\$350.00
Third Space Happy Place	\$350.00
Special Order*	

Consult Event Coordinator

18% service charge and applicable sales tax will be added to all hosted beverage sales. There is a \$100 bartender fee for each bartender required.

**Special product available for purchase. Please contact your event coordinator for details.*

Pricing and selections are subject to change.

Alcohol service is available starting at 5:00 p.m.

EV_FSS25P-YRBP_V021725

Recommended Concessionaires

A&W

Contact: James Brajdic
(920) 251-6847 | jamesjimmyb@aol.com

Dunkin' Donuts

Contact: Danielle Veith
(920) 791-0184 | danielleveithdd@gmail.com

El Agave Mexican Grill & Cantina

Contact: Renee Hernandez
(920) 327-3136 | el.agave2018@gmail.com

Faris Gourmet Popcorn

Contact: Alison Faris Helleberg
(920) 251-7544 | alison@farispopcorn.com

Golden Gourmet WaffleSticks

Contact: Fred Westerfield
(920) 205-6759 | goldengourmetwafflesticks@yahoo.com

Heritage Coffee

Contact: Amy Peiffer
(920) 360-3955 | heritagecoffeewi@gmail.com

Inferno Subs

Contact: Fred Westerfield
(920) 205-6759 | infernosubs@yahoo.com

Legendary Gyros

Contact: Fred Westerfield
(920) 205-6759 | legendarygyros@yahoo.com

Mr. & Mrs. Eggroll

Contact: Chee Vang
(920) 539-1193 | mrandmrseggroll@gmail.com

On the Fritz Concessions

Contact: Kyle Fritz
(920) 475-2102 | onthefritzconcessions@gmail.com

Osorio's Latin Fusion

Contact: Kimberly Finnell
(920) 955-3766 | osorioslatinfusion@gmail.com

Papa John's Pizza

Contact: Mary Ziola-Vega
(708) 289-0596 | maryzvpapajohns@gmail.com

Travelin' Tom's Coffee

Contact: John Dietzen
(920) 284-1265 | jdietzen@travelintomscoffee.com



*ALL alcoholic beverage service
must be contracted through EAA.*

EAA Hotel Partners

Oshkosh

Comfort Suites

400 South Koeller Street, Oshkosh, WI 54902
(920) 230-7378

Fairfield Inn & Suites

1800 S. Koeller St., Oshkosh, WI 54902
(920) 233-8504

Hilton Garden Inn

1355 West 20th Avenue, Oshkosh, WI 54902
(920) 966-1300

Holiday Inn Express Hotel & Suites

2251 Westowne Avenue, Oshkosh, WI 54904
(920) 303-1300

La Quinta Inn

1886 Rath Lane, Oshkosh, WI 54904
(920) 233-4190

Oshkosh Marriott Waterfront Hotel & Convention Center

1 North Main Street, Oshkosh, WI 54901
(920) 230-3200

TownePlace Suites

1365 North Westfield Street, Oshkosh, WI 54902
(920) 891-8500

Appleton

Candlewood Suites

4525 W College Avenue, Appleton, WI 54914
(920) 739-8000

Comfort Inn & Suites Appleton

3809 West Wisconsin Avenue, Appleton, WI 54914
(920) 730-3800

Home2Suites

5115 West Grande Market Drive, Grand Chute, WI 54913
(920) 739-8440

La Quinta Inn & Suites Appleton

3800 West College Avenue, Appleton, WI 54914
(920) 734-7777

Hampton Inn

350 North Fox River Drive, Appleton, WI 54913
(920) 954-9211

Hilton Garden Inn

720 Eisenhower Drive, Kimberly, WI 54136
(920) 730-1900

Residence Inn

310 N Metro. Dr., Appleton, WI 54913
(920) 954-0570

Wingate

132 North Mall Drive, Appleton, WI 54913
(920) 954-0202

Fond du Lac

Comfort Inn

77 Holiday Lane, Fond du Lac, WI 54937
(920) 921-4000

Holiday Inn Express Hotel & Suites

55 Holiday Lane, Fond du Lac, WI 54937
(920) 204-0400

Radisson Hotel & Conference Center

625 West Rolling Meadows Drive, Fond du Lac, WI 54937
(920) 923-1440

Green Bay

Lodge Kohler

1950 South Ridge Road, Green Bay, WI 54304
(920) 456-4537

Neenah

Cobblestone Hotel & Suites Neenah

1465 Bryce Drive, Neenah, WI 54956
(920) 751-0071

EAA Approved Rental Providers

*Please note if an event at EAA requires equipment rental, equipment must be rented from one of the vendors on this list.**

Please contact your event coordinator for more information.

Fox Cities Party Rental

foxcitiespartyrental.net

Contact: Jared Wildes

jared@foxcitiespartyrental.net

JK Rentals

jkrentals.com

Contact: Kurt Goeman

kurt@jkrentals.com

Wisconsin Expo

wisconsinexpo.com

Contact: DJ Cartledge

djcartledge@wi-expo.com

Wolf River Expo Services

wolfriverexpo.com

Contact: Steve Cegielski

steve@wolfriverexpo.com



**For all events excluding EAA AirVenture Oshkosh*

EV_FSS25P-SSARPU_V021725



EAA Events | 3000 Poberezny Road, Oshkosh, WI 54902 | 800-300-9290 | events@eaa.org